

Receiver Specification

| | | | |
|-------------|-----------------------|---|------------------------------------|
| Our Part No | | 10M03H-16WF16-6J26 | |
| Size | Diameter 10mm | Total Height | 3.8mm |
| No. | Item | Specification | Testing Condition |
| 1. | Rated Imp | 16ohm \pm 15% | At 1 kHz 1.0V |
| 2. | D.C Impedance | 14.7ohm \pm 10% | At 20°C |
| 3. | Output S.P.L. | 108 \pm 3dB | At 1mW IEC318 1KHz |
| 4. | Input Power | Rated Power: 20mW | Max Power: 30mW |
| 5. | Frequency Range | 300---3KHz | Output S.P.L. -10dB |
| 6. | Operation | Must Be Normal | Program Source 20mW |
| 7. | Buzzes & Rattles | Must Be Normal | Sin Wave 0.56V |
| 8. | Load Testing | After Test Meet 2&7 | 20mW 48hours White Noise |
| 9. | Distortion | 5% Max | Input Rated Power at 1000Hz |
| 10. | Heat Testing | After Test 7&8&9 | +60°C \pm 3°C 48hours |
| 11. | Cold Testing | After Test 7&8&9 | -25°C \pm 3°C 48hours |
| 12. | Humidity Testing | After Test 7&8&9 | 40°C \pm 2°C 90~95% R.H. 48hours |
| 13. | Insulation Resistance | 1M Ω | Dc100v FRA. And TER. |
| 14. | Magnet Size | \varnothing 4.7 \times 0.7 | N42 |
| 15. | Net Weight | 1.9 g/PC | |
| 16. | Polarity | When a positive D.C voltage is applied to the terminal marked (+) or red, the diaphragm should move to the front. | |

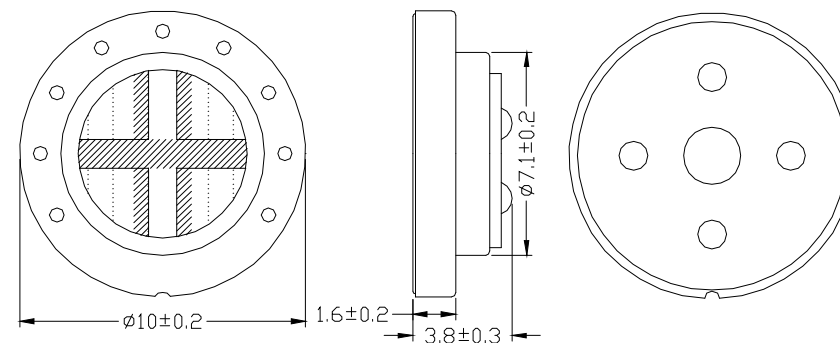
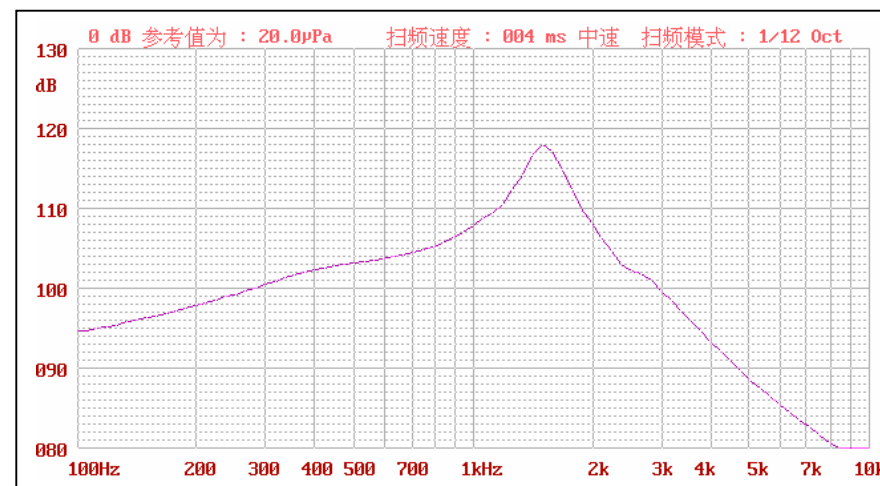

POWER SOUND ELECTRONICS LTD. - Acoustic Components Manufacturer

Tel: +86-755-8423 5076,8423 5093,8423 5316 Fax: +86-755-8423 5085 E-mail: psound@szonline.net

<http://www.chnpowersound.com>